



Nireeka Smart Electric Bike

User's manual

Prime Series

Original instructions

User's manuals in other languages are available at <http://www.nireeka.com>

CONTENTS

IMPORTANT NOTICE	3
IMPORTANT SAFETY INFORMATION	3
HANDLING THE BATTERY	3
TO ENSURE SAFE RIDING	4
USING THE PRODUCT SAFELY	4
DISCLAIMER OF WARRANTIES; LIMITATION OF LIABILITY	5
USER COMMENT, FEEDBACK, AND OTHER SUBMISSIONS TO ANY OF OUR OFFICIAL CHANNELS	6
QUICK INSTALLATION	7
UNPACKING	8
INSTALLING THE FRONT WHEEL	9
INSTALLING THE HANDLEBAR	11
INSTALLING THE PEDALS	12
INSTALLING THE DISPLAY	13
ON/OFF BUTTON	13
BATTERY AND CHARGER	14
THE LED INDICATORS	15
REMOVING THE BATTERY	16
REINSTALLING THE BATTERY	16
CHARGING THE BATTERY	17
DISPLAY	18
BIKE PARTS	24
STEM	25
SADDLE/SEATPOST	25
THROTTLE (For models with Throttle)	26
ADJUSTING SUSPENSION FORK (Optional)	26
GROUPSETS	27

For maximum safety, be sure to read this user's manual thoroughly before use, and follow them for correct use.

- **IMPORTANT NOTICE**

- Do not disassemble or alter this product.
- Use the product according to local laws and regulations.
- The Bluetooth® word, mark, and logo are registered trademarks owned by the Bluetooth SIG, Inc., and any use of such marks by SHOJAIE MOTORS INC. is under license. Other trademarks and trade names are those of their respective owners.

- **IMPORTANT SAFETY INFORMATION**

Guidelines that require replacement, contact the place of purchase, or a bike dealer.

Be sure to observe the following to avoid burns or another injury from fluid leakages, overheating, fire or explosions.

- **HANDLING THE BATTERY**

- Do not deform, modify, disassemble, or apply solder directly to the battery. Doing so may cause leakage, overheating, bursting, or ignition of the battery.
- Do not leave the battery near sources of heat such as heaters. Do not heat the battery or throw it into a fire. Doing so may cause bursting or ignition of the battery.
- Do not subject the battery to strong shocks or throw it. If this is not observed, overheating, bursting, or fire may occur.
- Do not place the battery into freshwater or seawater and do not allow the battery terminals to get wet. Doing so may cause overheating, bursting, or ignition of the battery.
- Use the Nireeka specified charger and observe the specified charging conditions when charging the specified battery. Not doing so may cause overheating, bursting, or ignition of the battery.

- **TO ENSURE SAFE RIDING**

- Do not give too much of your attention to the cycle computer display while riding, otherwise, accidents may result.
- Check wheels installed securely to the bike before commence riding. If wheels are not securely installed, the bike may fall over and serious injury may result.
- If riding on power-assisted mode, make sure that you are fully familiar with the starting-off characteristics of the bike before riding on roads with several vehicle lanes and pedestrian footpaths. If the bike starts-off suddenly, accidents may result.
- Check that the bike lights illuminate before riding at night.

- **USING THE PRODUCT SAFELY**

- Be sure to remove the battery and charging cable before wiring or attaching parts to the bike. Otherwise, an electric shock may result.
- When charging the battery while it is installed on the bike, do not move the bike. The power plug for the battery charger may come loose and not be fully inserted into the electrical outlet, resulting in a risk of fire.
- When installing this product, be sure to follow the instructions given in the user's manual. Furthermore, it is recommended that you use only genuine Nireeka parts at these times. If bolts and nuts are left loosened or the product is damaged, the bike may suddenly fall over and serious injury may result.
- Do not disassemble the product. Disassembling may cause injury to persons.
- After reading the user's manual carefully, keep it in a safe place for later reference.

- **DISCLAIMER OF WARRANTIES; LIMITATION OF LIABILITY**

You expressly agree that your use of, or inability to use, the service is at your sole risk. The service and all products and services delivered to you through the service are (except as expressly stated by us) provided 'as is' and 'as available' for your use, without any representation, warranties, or conditions of any kind, either express or implied, including all implied warranties or conditions of merchantability, merchantable quality, fitness for a particular purpose, durability, title, and non-infringement.

In no case shall NIREEKA E-BIKES, our directors, officers, employees, affiliates, agents, contractors, interns, suppliers, service providers, or licensors be liable for any injury, loss, claim, or any direct, indirect, incidental, punitive, special, or consequential damages of any kind, including, without limitation lost profits, lost revenue, lost savings, loss of data, replacement costs, or any similar damages, whether based in contract, tort (including negligence), strict liability or otherwise, arising from your use of any of the service or any products procured using the service, or for any other claim related in any way to your use of the service or any product, including, but not limited to, any errors or omissions in any content, or any loss or damage of any kind incurred as a result of the use of the service or any content (or product) posted, transmitted, or otherwise made available via the service, even if advised of their possibility. Because some countries or states or jurisdictions do not allow the exclusion or the limitation of liability for consequential or incidental damages, in such areas, our liability shall be limited to the maximum extent permitted by law.

- USER COMMENT, FEEDBACK, AND OTHER SUBMISSIONS TO ANY OF OUR OFFICIAL CHANNELS

If at our request, you send certain specific submissions (for example contest entries) or without a request from us you send creative ideas, suggestions, proposals, plans, or other materials, whether online, by email, by postal mail, or otherwise (collectively, 'comments'), you agree that we may, at any time, without restriction, edit, copy, publish, distribute, translate and otherwise use in any medium any comments that you forward to us. We are and shall be under no obligation (1) to maintain any comments in confidence; (2) to pay compensation for any comments; or (3) to respond to any comments.

We may, but have no obligation to, monitor, edit or remove content that we determine in our sole discretion are unlawful, offensive, threatening, libelous, defamatory, pornographic, obscene, or otherwise objectionable or violates any party's intellectual property or these Terms of Service.

You agree that your comments will not violate any rights of any third-party, including copyright, trademark, privacy, personality, or other personal or proprietary rights. You further agree that your comments will not contain libelous or otherwise unlawful, abusive or obscene material, or contain any computer virus or other malware that could in any way affect the operation of the Service or any related website. You may not use a false e-mail address, pretend to be someone other than yourself, or otherwise mislead us or third-parties as to the origin of any comments. You are solely responsible for any comments you make and their accuracy. We take no responsibility and assume no liability for any comments posted by you or any third-party.

Disclaimer

The battery should be charged for at least 4 hours every two weeks if the bike is not used for any reason or the cells will be corrupted and the warranty doesn't cover that.

Bicycling involves the risk of injury and damage. By choosing to ride a bike, you assume full responsibility for the risks. Know the rules of safe and responsible riding and practice them. It is up to you to ensure you know how to use and maintain your bike. Do not ride the bike if you see a defective part or damage or any probable injury will be your responsibility. Be sure to always ride with a helmet.

Be aware that trail and road conditions are constantly changing. Use caution when bicycling and be aware that directions and advice in this Guide may not always reflect real-world conditions.

Nireeka Technologies Inc. is not responsible for personal injury or damage to personal property arising in conjunction with using this Guide. Sound judgment and proper preparation are essential to traveling by bike. Before heading out onto a bikeway, it is recommended that you check with other sources of information for the latest trail/road conditions.

QUICK INSTALLATION

UNPACKING

Check the box carefully for any damage.

Put the box on the ground and pull the package out by grabbing the frame and rear wheel.

The package includes:

- Nireeka Prime fully-assembled bike
- Front-wheel
- Saddle
- Battery
- Charger
- Battery key (Inside the Charger box)
- User's Manuals
- Pedals

*Your upgrades are included.

ATTENTION:

The bike is fully assembled. The only part that needs to be assembled, is the front wheel and the handlebar.

INSTALLING THE FRONT WHEEL

The front wheel hub is the **thru-axle** model.

1. Pull out the brake's pad protector gently.

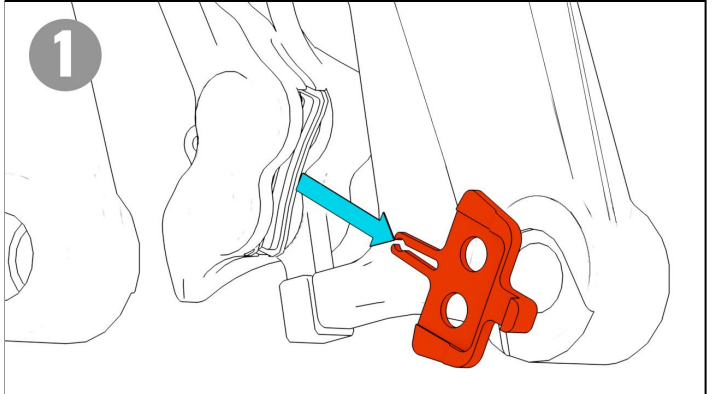

2. Locate the rotor inside the brake's caliper and align the hub in the front fork dropout.

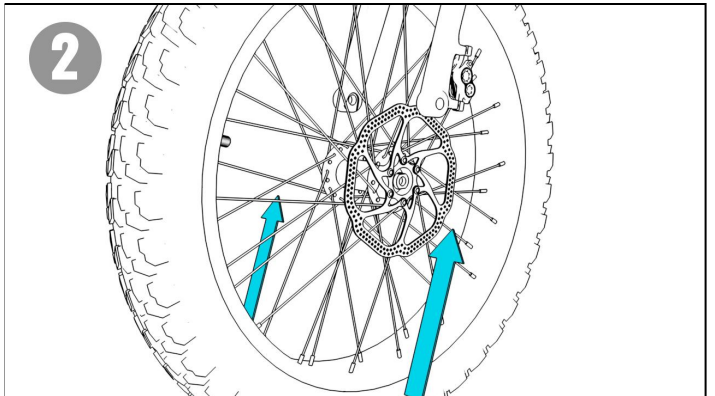

NOTE: When installing the front wheel in the fork, make sure the brake pads aren't dislodged.

WARNING

Check the lever to be secured or it causes serious damage or death.

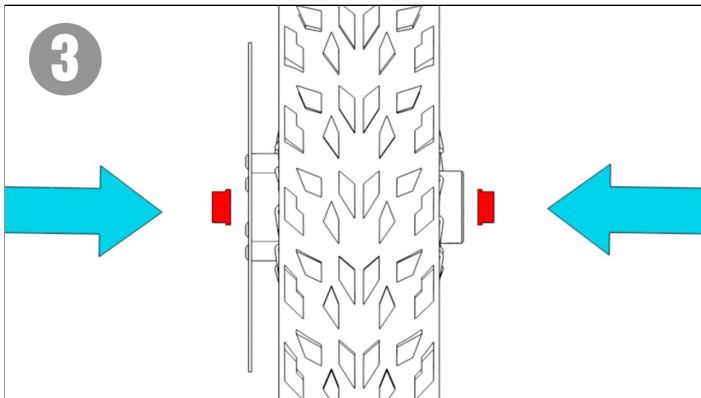

3. Insert two pieces of bushings on the right and left sides according to the picture.

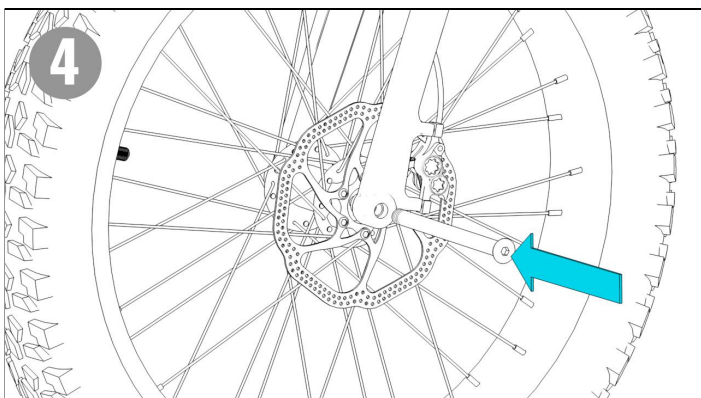

4. Insert the thru-axle shaft from the rotor side.

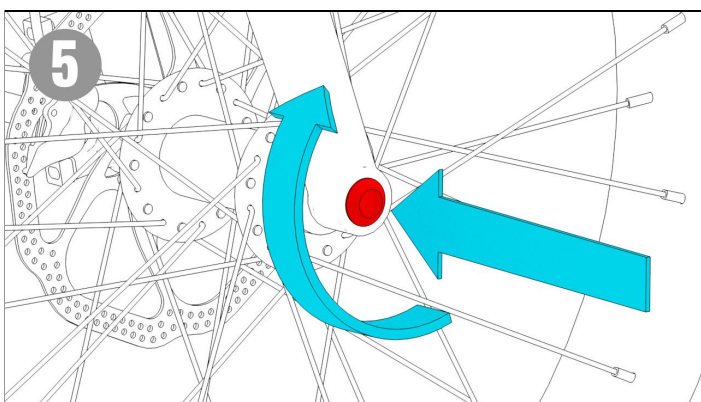

5. Fasten the shaft's nut using a 7/8" (22mm) open-end wrench. (Torque: 9-13.5 N.m)

INSTALLING THE HANDLEBAR

1. Adjust the handlebar in the proper and straight position.

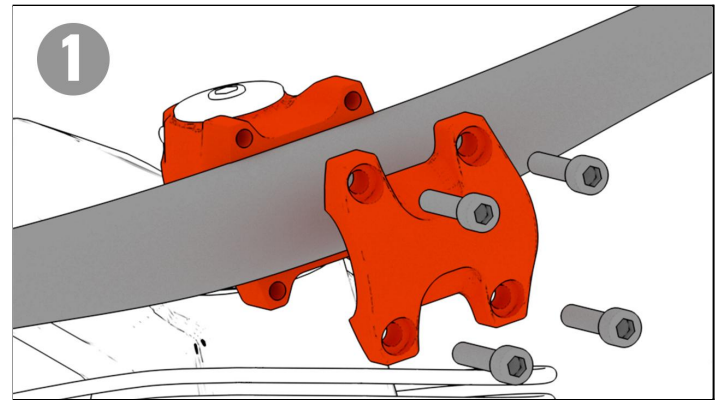

2. Fasten the bolts on the back of the stem respectively.

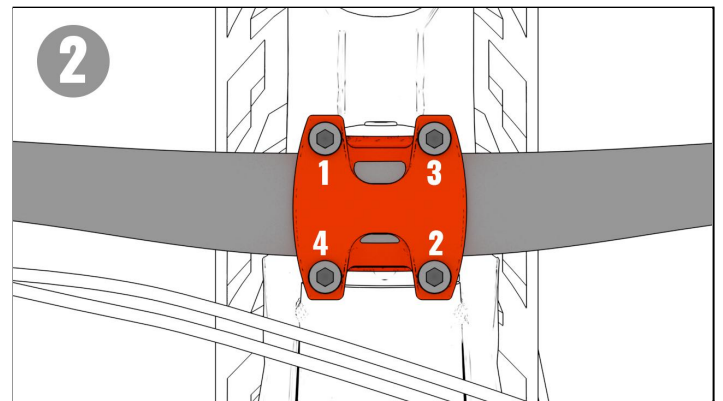

INSTALLING THE PEDALS

1. There is a small letter on each pedal indicating that on which side it should be installed. You need to install each pedal on the correct side of the Crank Arm. "L" stands for Left and "R" stands for Right.
2. If you're standing on the right side of the bike, the right pedal should be tightened clockwise using a 6mm allen key, as shown on the picture.
3. If you're standing on the left side of the bike, the left pedal should be tightened anticlockwise using a 6mm allen key, as shown on the picture.

Note: You can also use a 15mm open-end wrench instead of Allen key.

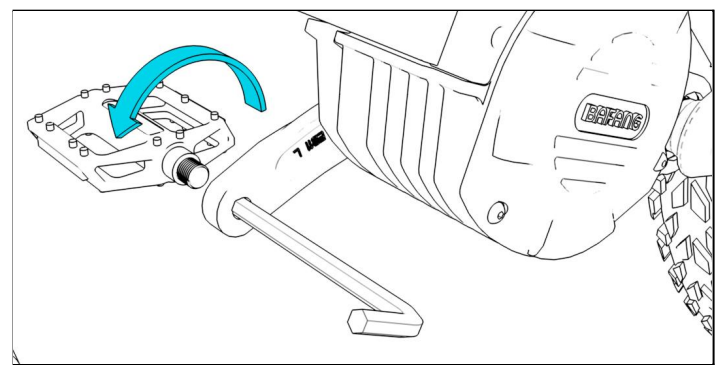
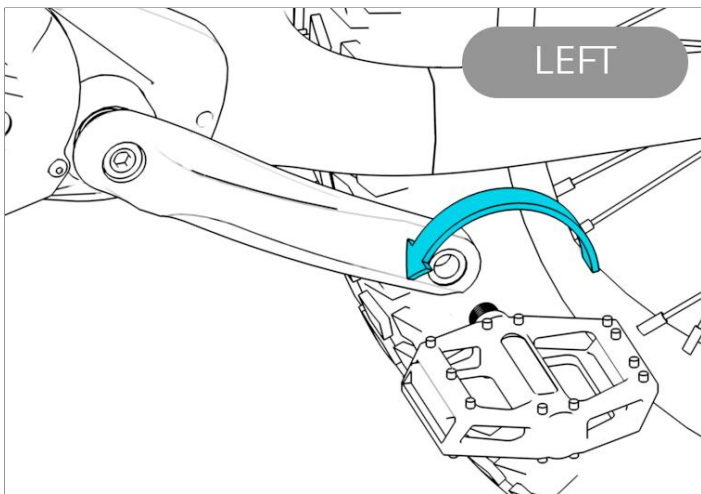
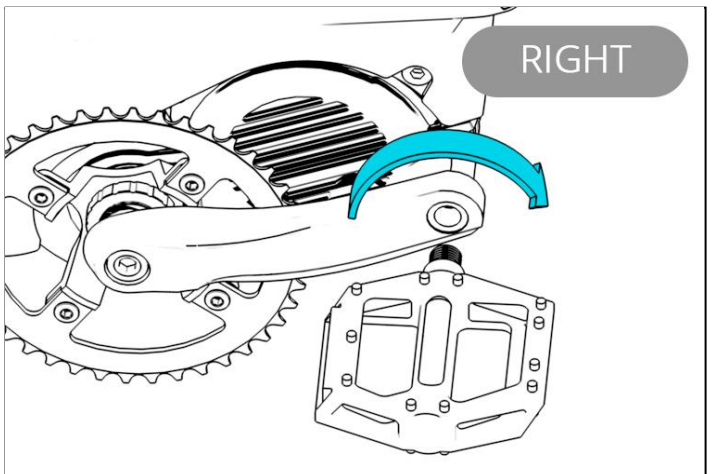
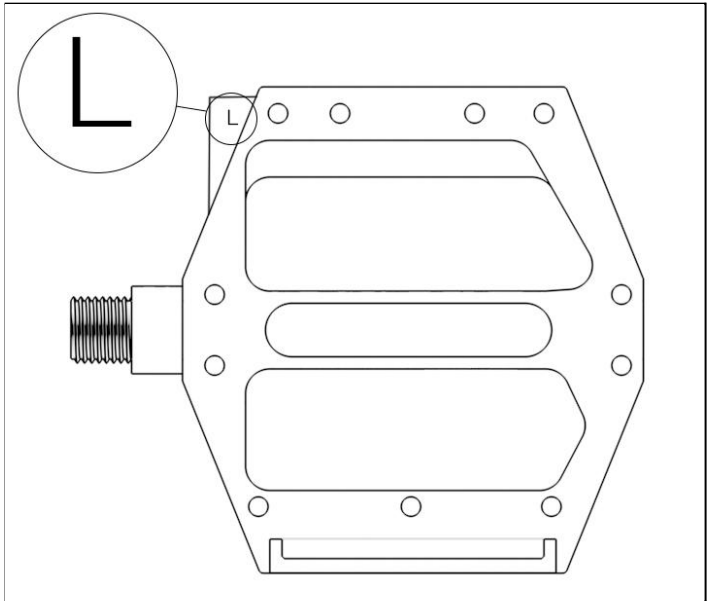

INSTALLING THE DISPLAY

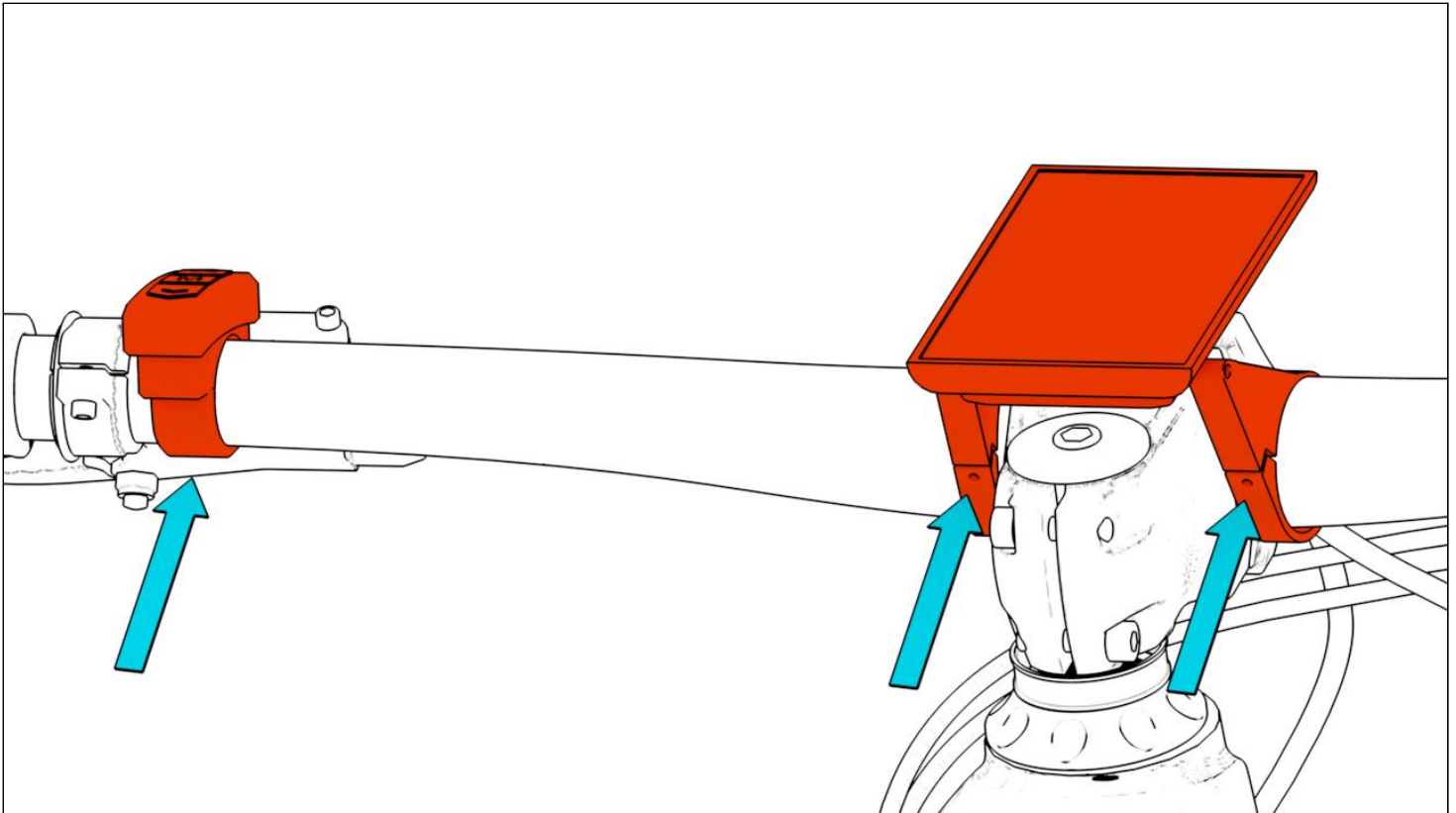

1. Open the clamp band's screw and install it on the correct place over the handlebar.
2. Adjust the angle of the display so that it is easy to be seen while riding, and then use a 3mm allen key to tighten the clamp bolt. (Torque: 0.8 N·m)

ON/OFF BUTTON

To turn on the power, press and hold (>2 Sec.) to power on the display. The display begins to operate. Press and hold (>2 Sec.) again to power off the display.

NOTE: After 5 minutes of inactivity, the display will be automatically turned off.

BATTERY AND CHARGER

THE LED INDICATORS

1. **Power Button:** Press this button to turn the battery on before installing on the bike.
2. **Battery LEDs:** Press the button to see the four LED indicators. When all 4 LEDs are on, it means that the battery is fully charged. As it is being discharged, the LEDs will turn off one by one. (Figure A)
3. **Discharge Connector:** This connector plugs to the male side on the battery bracket when the battery is installed on the bike.

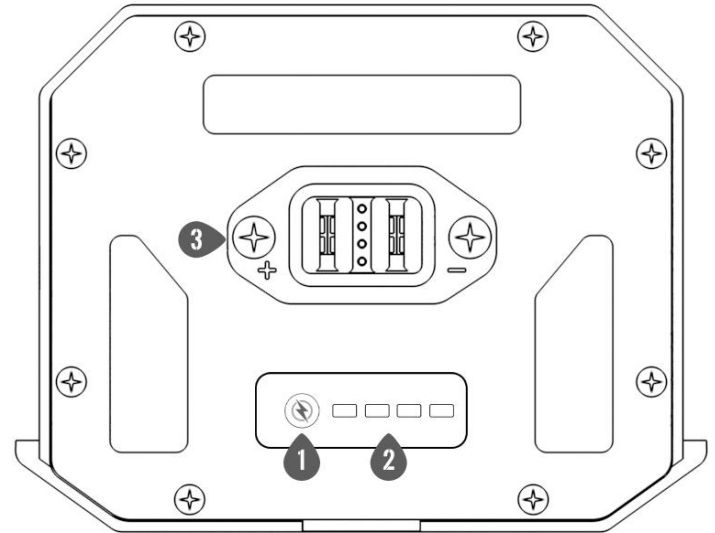

Charger LEDs: When green, either the battery is not connected or the battery is fully charged. When red, it means the battery is charging. The charger has a smart cut-off system. When the battery is fully charged, it turns off automatically.

Sleep Mode: Some batteries have a sleep feature that turns off the battery if it's not being used for more than 12 hours. The power button needs to be pressed to wake the battery up.

ATTENTION:

All the batteries are identical in dimensions regardless of the capacity.

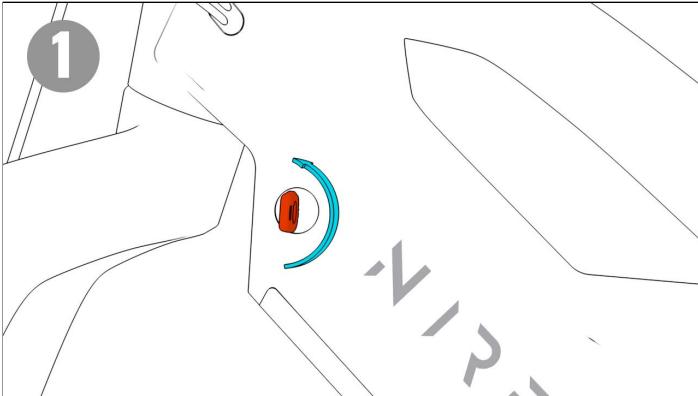

REMOVING THE BATTERY

1. The battery lock is placed on the left side of the bike. Rotate the key anticlockwise to unlock it with your left hand.
2. The battery drops in your right hand. Pull it off to remove the battery.

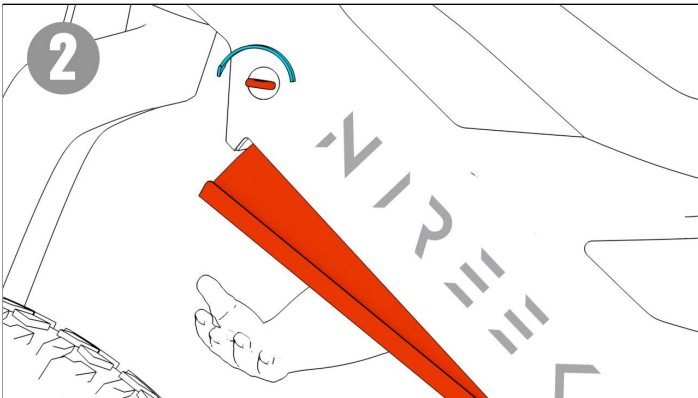

WARNING

Make sure you keep your hand under the battery before unlocking it or the battery may drop resulting in injury or damage to the battery.

REINSTALLING THE BATTERY

1. Put the bottom side of the battery into the frame.
2. Push the battery into the frame to hear the click sound.

WARNING

Check carefully if the battery is secured. Dropping the battery while riding can cause serious damage.

CHARGING THE BATTERY

1. Connect the charger's power plug to the outlet.
2. Remove the waterproof socket cover on the battery.
3. Insert the charging plug into the battery's charging port.

ATTENTION: Charge the battery on a flat surface indoor, and do not leave it where you cannot see it during charging.

1. Bottom of the battery
2. Charging port

WARNING

- Do not leave the battery while charging.
- When charging the battery while it is mounted on the bike, be careful not to trip over the charger cord or get anything caught on it. This may lead to injury or cause the bike to fall over, or damaging the components.

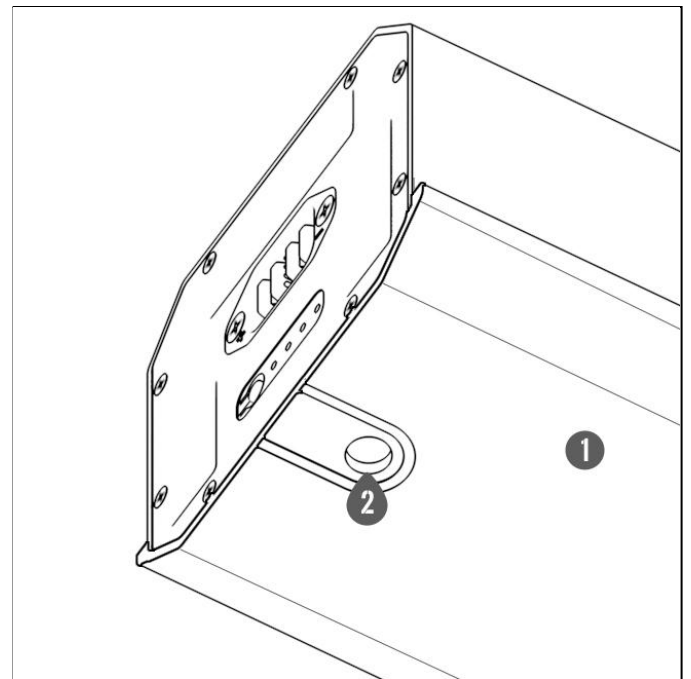
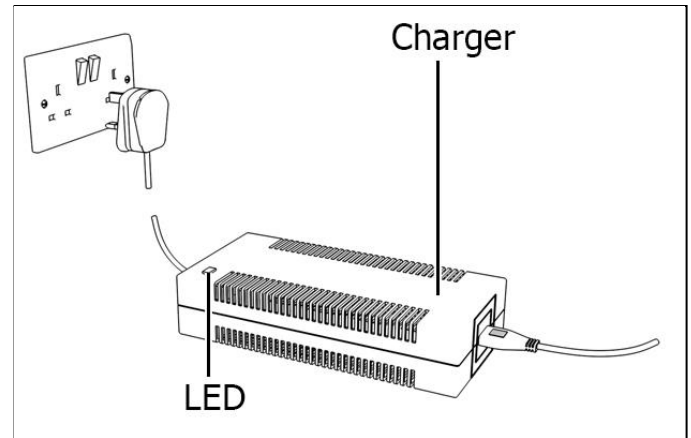

DISPLAY

DPC-C961 B/W DISPLAY



1. Power/Mode Button
2. "+" button
3. "-" button

Press and hold the power button to turn on the display/bike.

1. Battery capacity indication:

Display current battery level value.

2. General mode indication:

Displays current riding mode.

3. Assist levels indicator:

Displays the assist levels, briefly press (0.5S) **+** or **-** to switch between levels.

4. Walk assistance indicator:

In the power-on status, press the **-** button and hold it for three seconds to enter the walk assistance mode. Release the button to return to the ride mode.

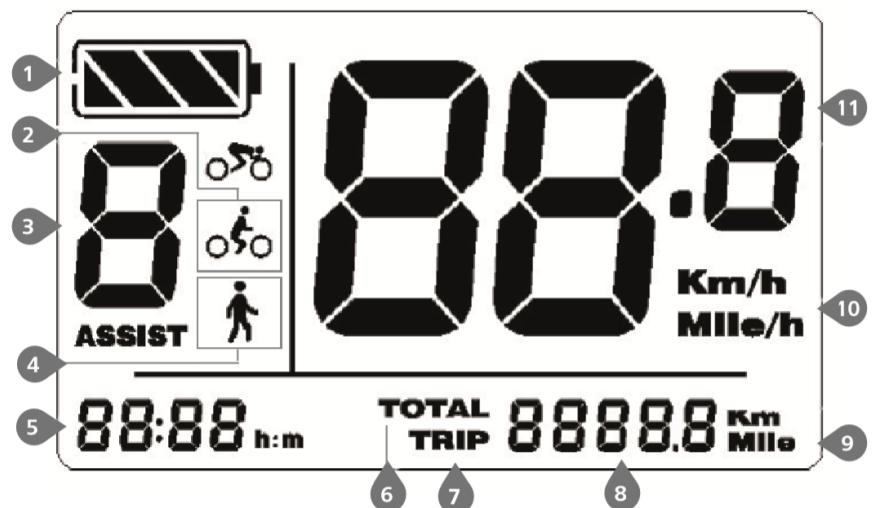

5. **Time indicator:** Displays current time.
6. **ODO indicator:** It will record your total distance over time.
7. **Trip indicator:** Displays how much distance you have covered in a single trip.
8. **Trip data indicator:** Displays accurate data of ODO and Trip.
9. **Distance unit:** Displays distance unit chosen to be shown.
10. **Speed unit:** Displays speed unit chosen to be shown.
11. **Speed indicator:** Displays accurate speed of the bike.



1. Power button
2. Menu
3. Light
4. "+" button
5. "-" button

Press and hold the power button to turn on the display/bike.

1. **Time indicator:**

The time is represented in the 24-hour system and shows the current time, time can be set in the “Set clock” menu.

2. **USB charging indicator:**

When an external device connects to the display, it shows the USB symbol.

3. **Headlight indicator:**

Only shows when the headlight is on. (not implemented on Nireeka products)

4. **Speed scale indicator:**

The scale value is in accordance with the digital value.

5. **Selected mode indicator:**

Single-trip distance (TRIP) → Total distance ODO → Maximum speed (MAX) → Average speed (AVG) → Remaining distance (RANGE) → Energy consumption (CALORIES) → Time (TIME).

6. **Battery level indicator:**

Displays current battery level value.

7. **Voltage/percentage indicator:**

Displays actual battery level value, display mode can be set in the “Soc View”.

8. **Digital speed indicator:**

Displays current speed value. Speed unit can be set in “Unit”.

9. **Power/current scale indicator:**

Displays current output value, output unit can be set in “Power View” menu.

10. **Power/walk assistance indicator:**

Displays the levels as “0”/“1”/“2”/“3”/ “4”/ “5”/“”. Briefly press (0.5S) **+** or **-** to switch the level. Touch and hold (2S) to start “walk assistance” mode.

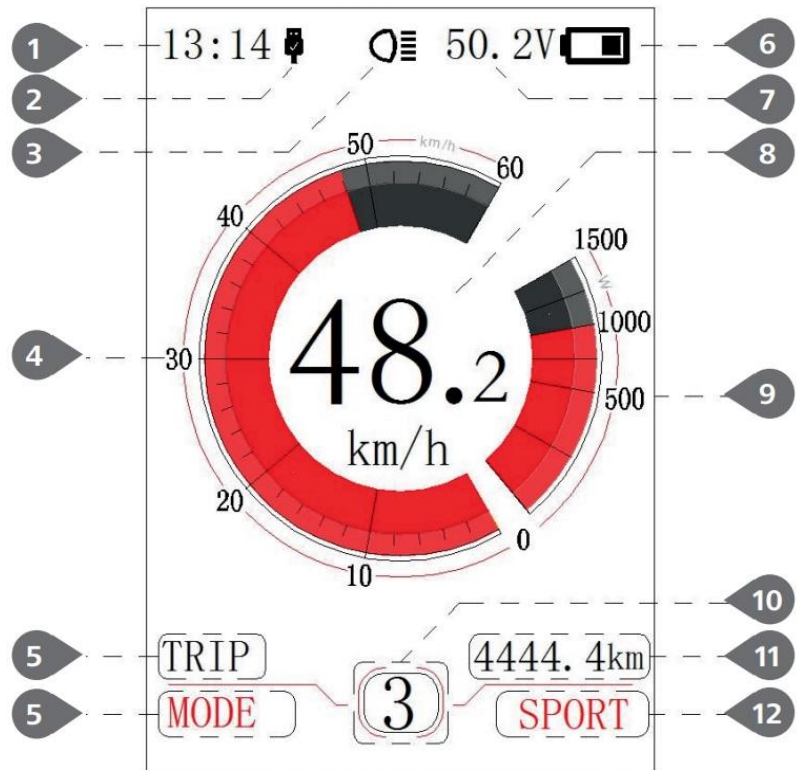

11. Data indicator:

Displays current data corresponding to the related mode.

12. Riding mode indicator:

The current riding mode, "SPORT" or "ECO", can touch and hold (2S) to switch between modes.

BIKE PARTS

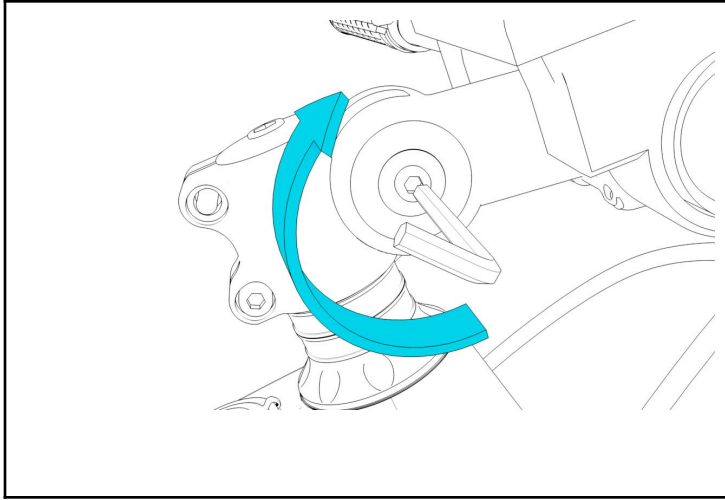

STEM

Nireeka comes with two types of stems:

1. Adjustable
2. Normal

ADJUSTING ADJUSTABLE STEM: Loosen the screws on the right side with an allen key, then adjust the height to the desired degree and finally tighten the screw.

SADDLE/SEATPOST

1. Install your Seatpost by loosening the allen bolt where the Seatpost slides into the frame.
2. Twist the seat to raise or lower the post as needed and then tighten the bolt.

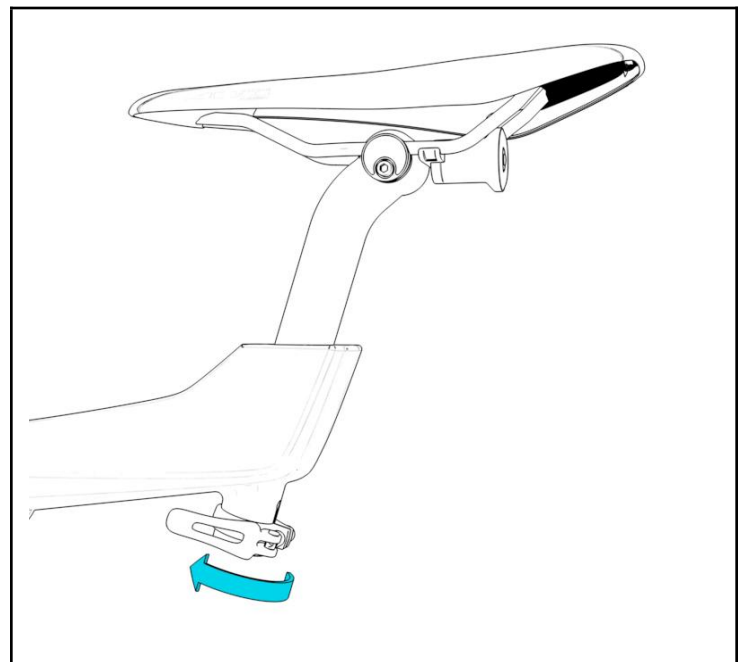

THROTTLE *(For models with Throttle)*

Nireeka Prime comes with a thumb throttle installed on the left side of the handlebar. It connected to the controller through the wire.

When the display is on, push the throttle trigger gently to start moving.

WARNING

- Do not shift the gears when you're on full throttle/PAS 3 (or more) or the gears/the cassette might be damaged. You can only shift the gears when you're at a constant speed and not accelerating.

ADJUSTING SUSPENSION FORK *(Optional)*

1. To increase or decrease Low Speed Compression (LSC) damping or adjusting it's sagging, rotate the knob in the direction indicated.
2. The Lockout* setting prevents the fork from compressing until significant impact occurs. Rotate the lever, or actuate the remote, to lock and unlock the compression damper.

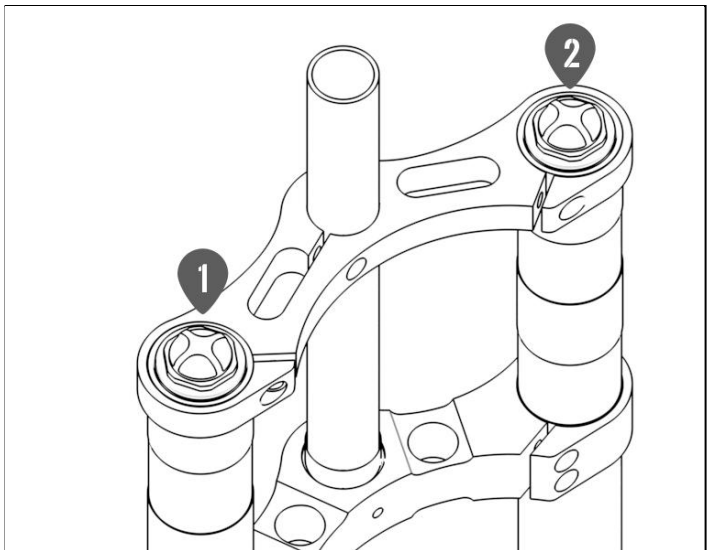

- ***Available in some models***

GROUPSETS

Nireeka Model	S-PART NO	SERIES	PART_CD	MODEL NO	DESCRIPTION
Prime (US&EU)	KSLM610RA	DEORE	SL	SLM610R	SHIFT LEVER, SL-M610, DEORE RIGHT 10-SPEED, 2050MM INNER W/ OPTICAL GEAR DISPLAY, BLACK
Prime (US&EU)	KRDM610SGSL	DEORE	RD	RDM610	REAR DERAILLEUR, RD-M610, DEORE, SGS 10-SPEED TOP-NORMAL, SHADOW DESIGN, DIRECT ATTACHMENT (DIRECT MOUNT COMPATIBLE), BLACK
Prime (US&EU)	KCSHG5010136	DEORE	CS	CSHG5010	CASSETTE SPROCKET, CS-HG50-10, 10-SPEED 11-13-15-17-19-21-24-28-32-36T (BK), PRE-ASSEMBLED (CS CAP)
Prime (US&EU)	E11-S	KMC	Electric	E11-S NP/BK	SUPER NARROW BICYCLE CHAIN FOR FAT EBIKE 10-SPEED CUSTOMIZED 128 LINKS, W/END PIN
Prime (US&EU)	AM60002JNFPR X095	DEORE	BD	BRM6000KIT M615	DISC BRAKE ASSEMBLED SET/J-kit, SHIMANO, BL-M6000(L), BR-M615(F), FOR POST MOUNT, RESIN PAD(W/O FIN), 950MM HOSE(SM-BH90-SS BLACK)
Prime (US&EU)	AM60002JTRXR X170	DEORE	BD	BRM6000KIT M615	DISC BRAKE ASSEMBLED SET/J-kit, SHIMANO, BL-M6000(R), BR-M615(R), W/O ADAPTER, RESIN PAD (W/O FIN), 1700MM HOSE(SM-BH90-SS BLACK)
Prime (US&EU)	SMRT56S	DEORE	RT	SMRT54	FRONT ROTOR/DISC BRAKE, SM-RT56-S 160MM, 6-BOLT TYPE
Prime (US&EU)	SMRT56M	DEORE	RT	SMRT56	REAR ROTOR/DISC BRAKE, SM-RT56-M 180MM, 6-BOLT TYPE
Prime (US&EU)	QUANDO	FAT	NK	NPFH-1	FRONT HUB, NKPFH-1, 32-HOLE, O.L.D.150MM. THRU AXLE SHAFT DIAMETER: 15MM (BLACK),

Website: <http://www.nireeka.com>

User's manuals in other languages are available at http://www.nireeka.com/user_manual

FAQ: <http://www.nireeka.com/faq>

Forums: <http://www.nireeka.com/forum>