



Nireeka Smart Electric Bike

---

## User's manual

**Homie and Street Series**

Original instructions

User's manuals in other languages are available at <http://www.nireeka.com>

## CONTENTS

IMPORTANT NOTICE	3
<b>Quick Installation</b>	<b>5</b>
UNPACKING	6
INSTALLING THE FRONT WHEEL	7
ADJUSTING HANDLEBAR	8
<b>BATTERY</b>	<b>10</b>
THE BATTERY	11
REMOVING THE BATTERY	12
RR-INSTALLING THE BATTERY	12
CHARGING THE BATTERY OFF THE BIKE	13
CHARGING THE BATTERY ON THE BIKE	13
	17
<b>BIKE PARTS</b>	<b>18</b>
HANDLEBAR	19
STEM	19
SADDLE/SEATPOST	20
THROTTLE (For models with Throttle)	20
IGNITION SWITCH	21
BLIND SPOT RADAR	21
<b>GROUPSETS</b>	<b>22</b>

## **IMPORTANT NOTICE**

- Do not disassemble or alter this product.
- Use the product according to local laws and regulations.
- The Bluetooth® word mark and logos are registered trademarks owned by the Bluetooth SIG, Inc., and any use of such marks by SHOJAIE MOTORS INC. is under license. Other trademarks and trade names are those of their respective owners.

**For safety, be sure to read this user's manual thoroughly before use, and follow them for correct use.**

## **Important safety information**

**Guidelines that require replacement, contact the place of purchase or a bike dealer.**

**Be sure to observe the following in order to avoid burns or another injury from fluid leakages, overheating, fire or explosions.**

### **To ensure safety**

#### **DANGER**

#### **Handling the battery**

- Do not deform, modify, disassemble or apply solder directly to the battery. Doing so may cause leakage, overheating, bursting, or ignition of the battery.
- Do not leave the battery near sources of heat such as heaters. Do not heat the battery or throw it into a fire. Doing so may cause bursting or ignition of the battery.
- Do not subject the battery to strong shocks or throw it. If this is not observed, overheating, bursting, or fire may occur.
- Do not place the battery into freshwater or seawater and do not allow the battery terminals to get wet. Doing so may cause overheating, bursting, or ignition of the battery.
- Use the Nireeka specified charger and observe the specified charging conditions when charging the specified battery. Not doing so may cause overheating, bursting, or ignition of the battery.

#### **WARNING**

#### **To ensure safe riding**

- Do not give too much of your attention to the cycle computer display while riding, otherwise, accidents may result.

- Check wheels installed securely to the bike before commence riding. If wheels are not securely installed, the bike may fall over and serious injury may result.
- If riding on power-assisted mode, make sure that you are fully familiar with the starting-off characteristics of the bike before riding on roads with several vehicle lanes and pedestrian footpaths. If the bike starts off suddenly, accidents may result.
- Check that the bike lights illuminate before riding at night.

### **Using the product safely**

- Be sure to remove the battery and charging cable before wiring or attaching parts to the bike. Otherwise, an electric shock may result.
- When charging the battery while it is installed on the bike, do not move the bike. The power plug for the battery charger may come loose and not be fully inserted into the electrical outlet, resulting in a risk of fire.
- When installing this product, be sure to follow the instructions given in the user's manual. Furthermore, it is recommended that you use only genuine Nireeka parts at these times. If bolts and nuts are left loosened or the product is damaged, the bike may suddenly fall over and serious injury may result.
- Do not disassemble the product. Disassembling may cause injury to persons.
- After reading the user's manual carefully, keep it in a safe place for later reference.

### **Disclaimer**

The battery should be charged for at least 4 hours every two weeks if the bike is not used for any reason or the cells will be corrupted and the warranty doesn't cover that.

Bicycling involves the risk of injury and damage. By choosing to ride a bike, you assume full responsibility for the risks. Know the rules of safe and responsible riding and practice them. It is up to you to ensure you know how to use and maintain your bike. Do not ride the bike if you see a defective part or damage or any probable injury will be your responsibility. Be sure to always ride with a helmet.

Be aware that trail and road conditions are constantly changing. Use caution when bicycling and be aware that directions and advice in this Guide may not always reflect real-world conditions.

Nireeka Technologies Inc. is not responsible for personal injury or damage to personal property arising in conjunction with using this Guide. Sound judgment and proper preparation are essential to traveling by bike. Before heading out onto a bikeway, it is recommended that you check with other sources of information for the latest trail/road conditions.

---

# Quick Installation

---

## UNPACKING

---

Check the box carefully for any damage.

Put the box on the ground and pull the package out by grabbing the frame and rear wheel.

The package includes:

Nireeka fully-assembled bike

Front wheel

Saddle

Battery

Charger

Battery key (Inside the Charger box)

Ignition key (Inside the Charger box)

User's Manuals

Front light (Only for Homie)

Mudguards

Pedals

Mobile holder

**ATTENTION:** The bike is fully assembled. The only parts that need to be assembled are the front wheel, handlebar and saddle. Here is a video guide for final assembling: <https://youtu.be/caGMFYI7UmM>

## INSTALLING THE FRONT WHEEL

The front wheel hub is the **quick release skewer** model. It consists of a rod threaded on one end and with a lever-operated cam assembly on the other. The rod is inserted into the hollow axle of the wheel, a special nut is threaded on, and the lever is closed to tighten the cam and secure the wheel to the fork.

The only part of the bike that needs assembling is the front wheel.

1. Put the front wheel axle in the right place.
2. Lock the QR lock.
3. Follow the Shimano user manual attached to the QR for more details.

### **WARNING**

Check the lever to be secured or it causes serious damage or death.

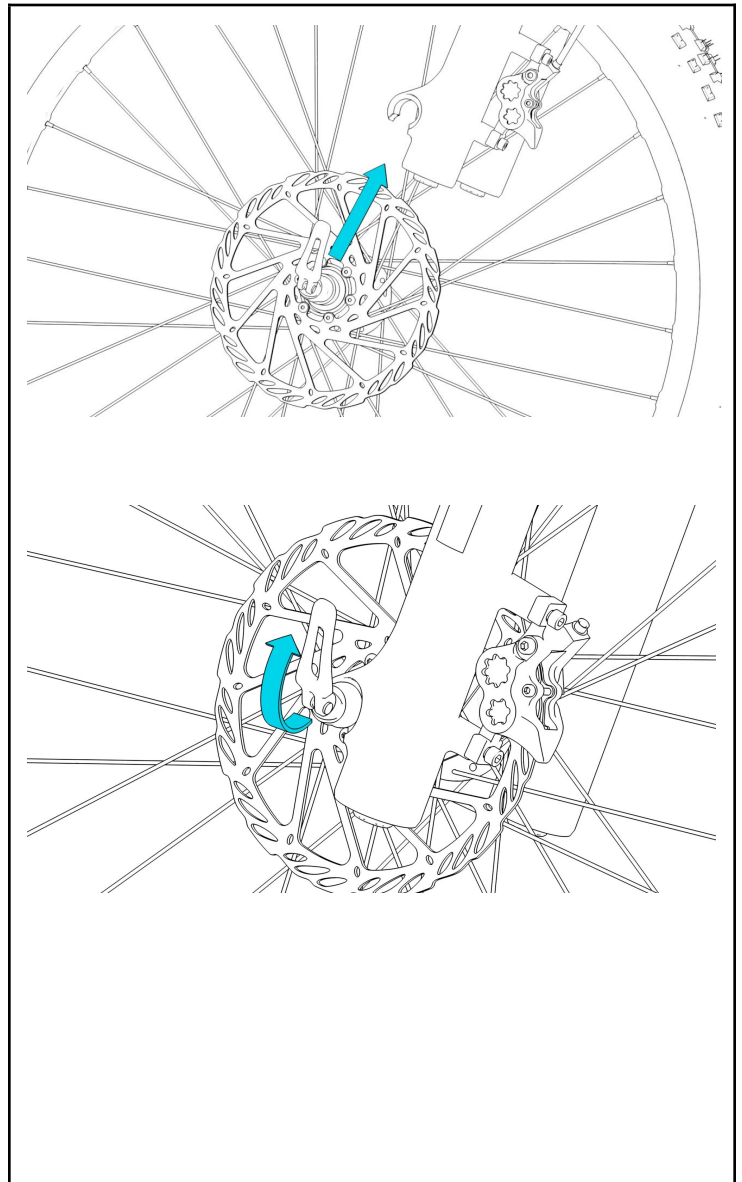

## ADJUSTING HANDLEBAR

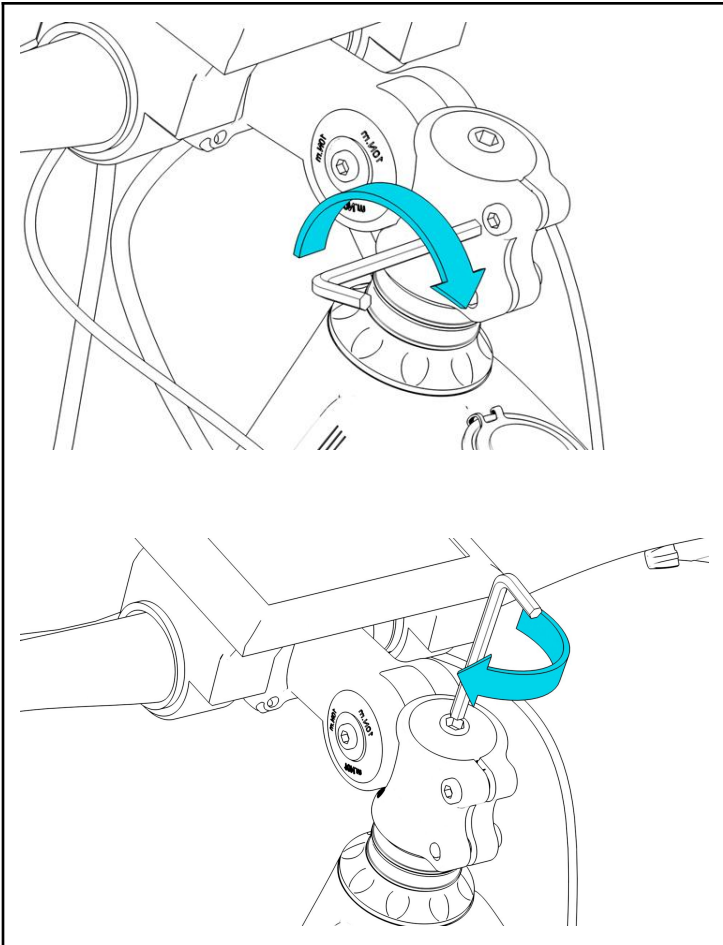

1. Adjust the handlebar in the proper position and the straight position.
2. Fasten clamp bolts on the back of the stem.
3. Fasten the top cap that sits on top of the stem.



---

# BATTERY

---

## THE BATTERY

---

**ATTENTION:** All the batteries are identical in dimensions regardless of the capacity.

**Charging indicator:** Press the button to see the five LED indicators. When all 5 LEDs are on (4 green, 1 red), it means that the battery is fully charged. As it is being discharged, the green LEDs will turn off one by one until all 4 green LEDs are off and only the red LED remains on which means that the battery is at around a 10% state of charge.

**Power button:** Turn on the battery by pressing this button and turn it off when you do not want to use it to avoid the battery drain.

**Charger LED:** When red, either battery is not connected or it's charging the battery. When green it means the battery is fully charged. The charger has a smart cut-off system. When the battery is fully charged, it turns off automatically.

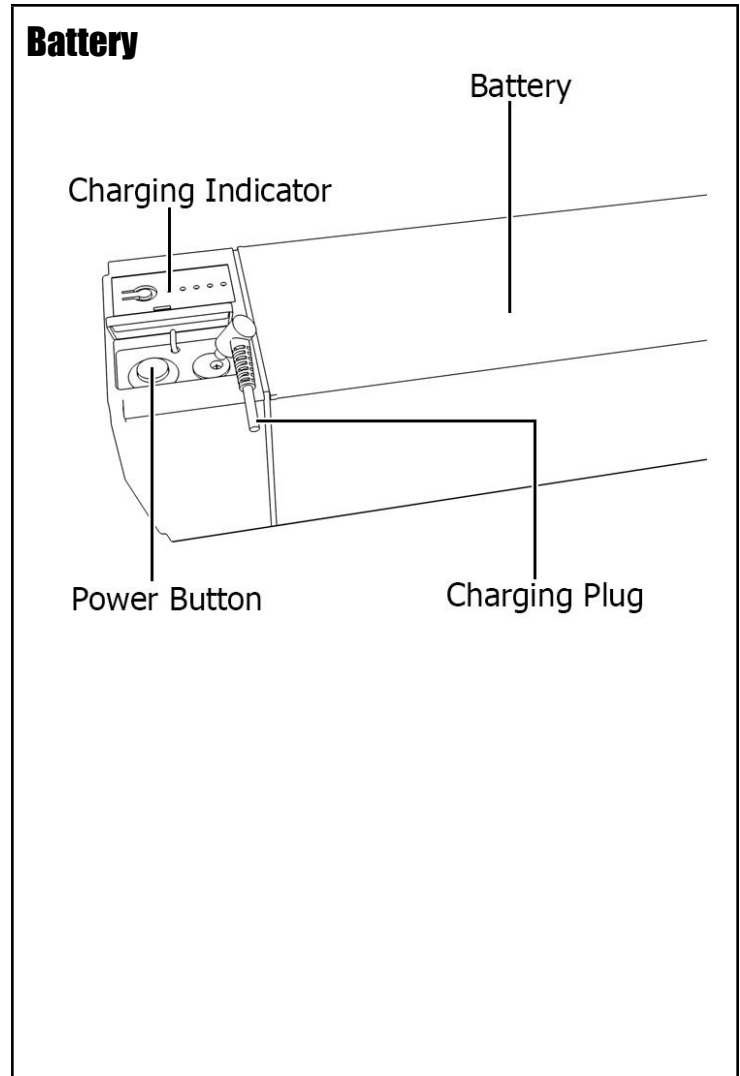

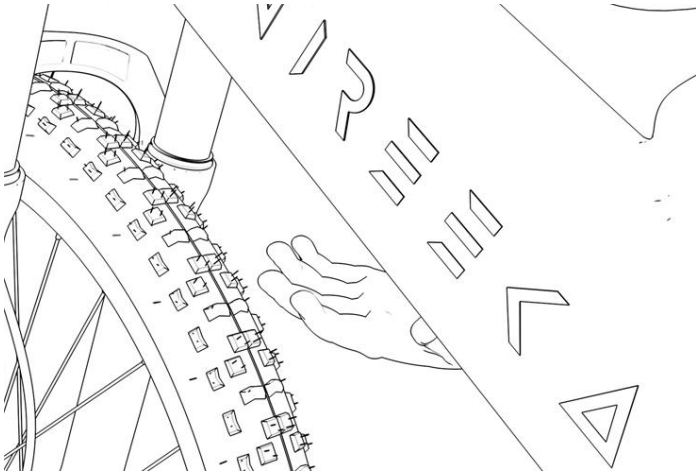
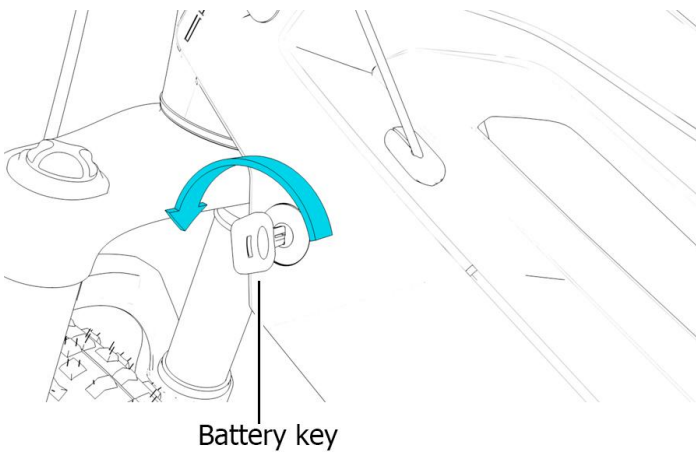
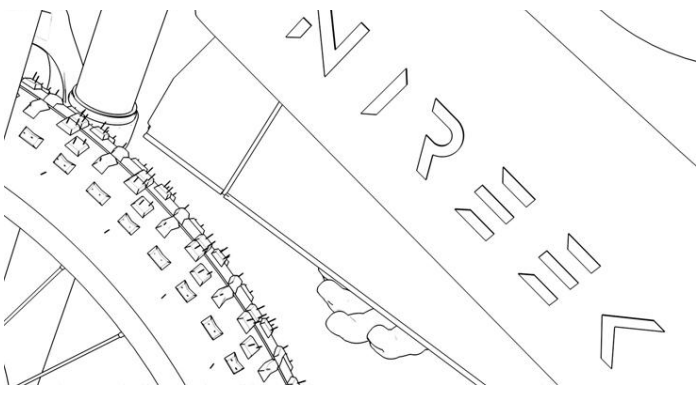
**Secure the battery****Unlocking****Remove the battery****REMOVING THE BATTERY**

1. Hold the battery with your right hand.
2. The battery lock is placed on the left side of the bike. Rotate the key in the right direction to unlock it with your left hand.
3. The battery drops in your hand. Pull it off to remove the battery.

**RR-INSTALLING THE BATTERY**

1. Put the bottom side of the battery into the frame.
2. Push the battery into the frame to hear the click sound.

**⚠ WARNING**

Check carefully if the battery is secured. Dropping the battery while riding can cause serious damage.

## CHARGING THE BATTERY OFF THE BIKE

1. Connect the battery charger power plug to the outlet.
2. Remove protector.
3. Insert the charging plug into the battery's charging port.

**ATTENTION:** Charge the battery on a flat surface indoors, when off the bike.

### **WARNING**

- Do not leave the battery while charging.
- When charging the battery while it is mounted on the bike, be careful not to trip over the charger cord or get anything caught on it. This may lead to injury or cause the bike to fall over, damaging the components.

## CHARGING THE BATTERY ON THE BIKE

1. Connect the battery charger power plug to the outlet.
2. Insert the charging plug into the battery charging port.

### Charger

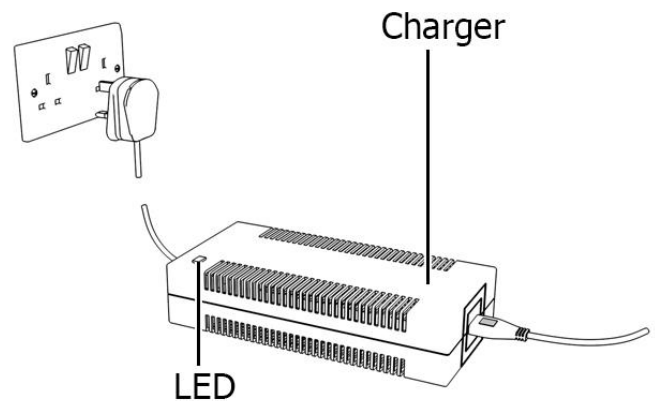

### The battery off the bike

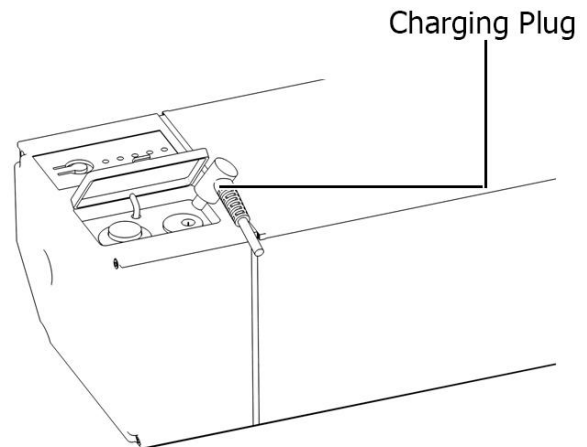

### The battery on the bike

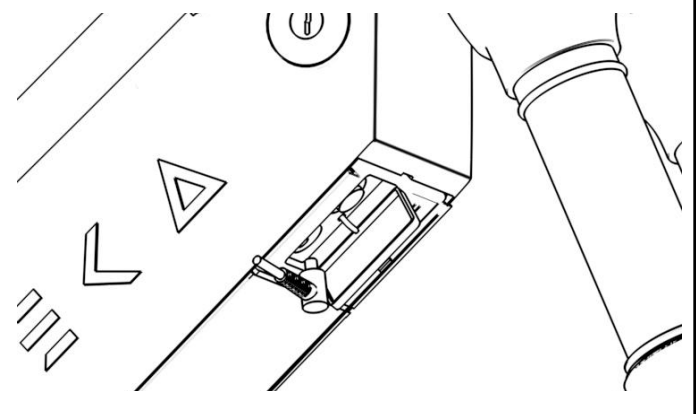

---

# **BIKE PARTS**

---

## HANDLEBAR

---

Nireeka comes with two types of handlebars:

1. Fiber carbon
2. Normal

**ATTENTION:** both types are similar in size, but the fiber carbon one is lighter and more durable.

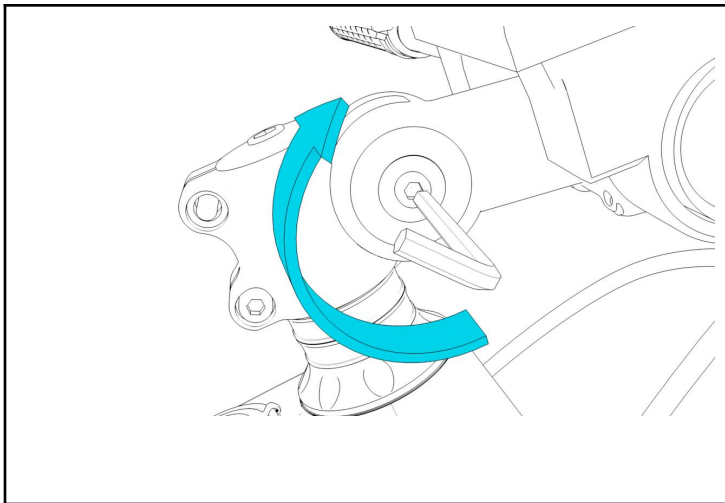
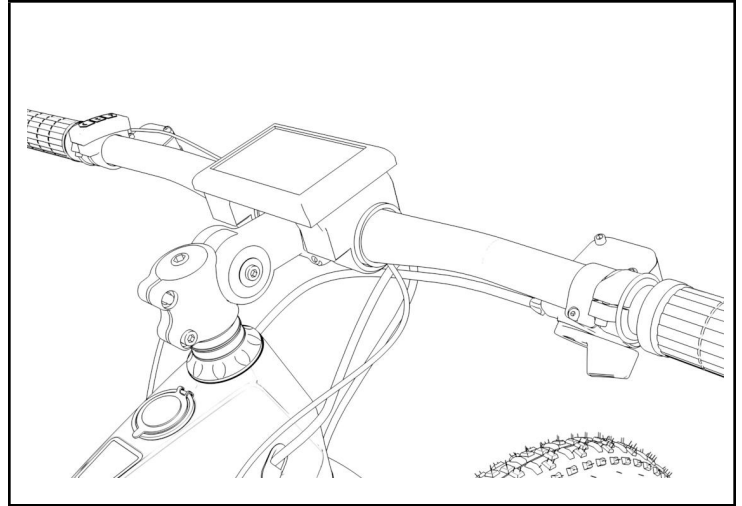

## STEM

---

Nireeka comes with two types of stems:

1. Adjustable
2. Normal

**Adjust Adjustable Stem:** Loosen the screw on the right side with an Allen key, then adjust the height to the desired degree and finally tighten the screw.

## SADDLE/SEATPOST

Installed on the frame with a seatpost, a tube that extends downwards from the seat to the frame.

Set the height of the seat: Place your heel on the pedal and pedal backward to reach the six o'clock position. Your knee should be completely straight.

After assessing proper height, use a small clamp to lose seatpost with your hand. Then set it to the proper height and after all, tighten it, simply put the clamp back to the starting position.

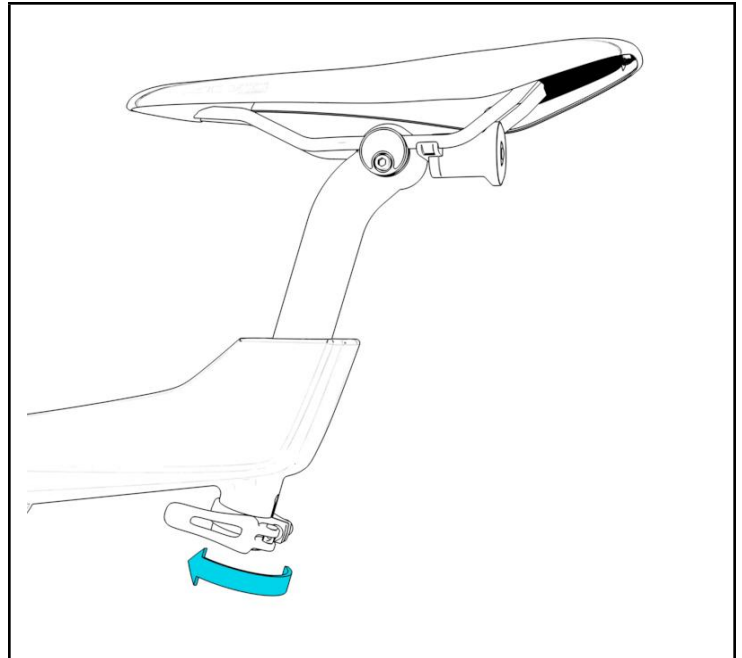

## THROTTLE *(For models with Throttle)*

Nireeka comes with two types of throttles:

1. Full Twist Throttle
2. Thumb Throttle

Twist throttle installed on the right end of the handlebar. It is connected to the ECU through the wire.

When the bike is on, just when you selected electric mode, twist it counterclockwise gently to start moving.

Thumb throttle installed on the right side of the handlebar.

When the bike is on, just when you selected electric mode, push it gently to start moving.

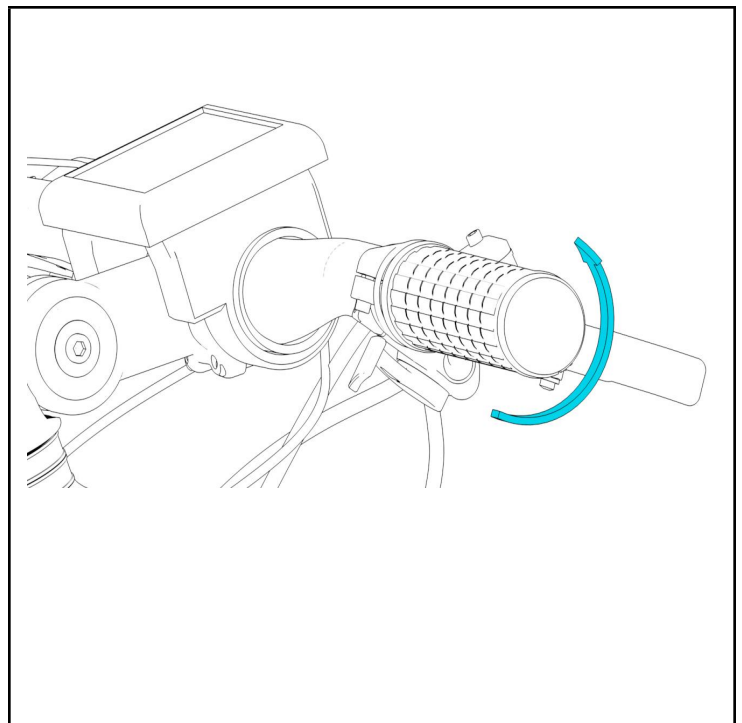

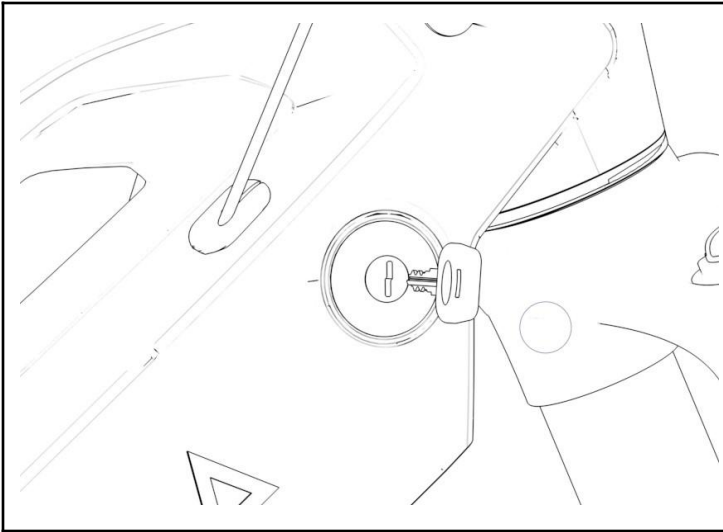

## IGNITION SWITCH

It is embedded on the right side of the frame. Use the turning key to turn the bike on or off. This will switch on/off the battery power.

## BLIND SPOT RADAR

Radars use ultrasonic technology to spot obstacles in blind spots of Nireeka.

Two sensors installed on the bike's rear axle to avoid cars and pedestrian collision. The smartphone screen on the application turns red and shows you an alarm in case of detection of an approaching vehicle to inform you of the existence of a vehicle in your blind spot. By the side of the red sign on the screen, the biker will get aware of which side object is in the blind spot.

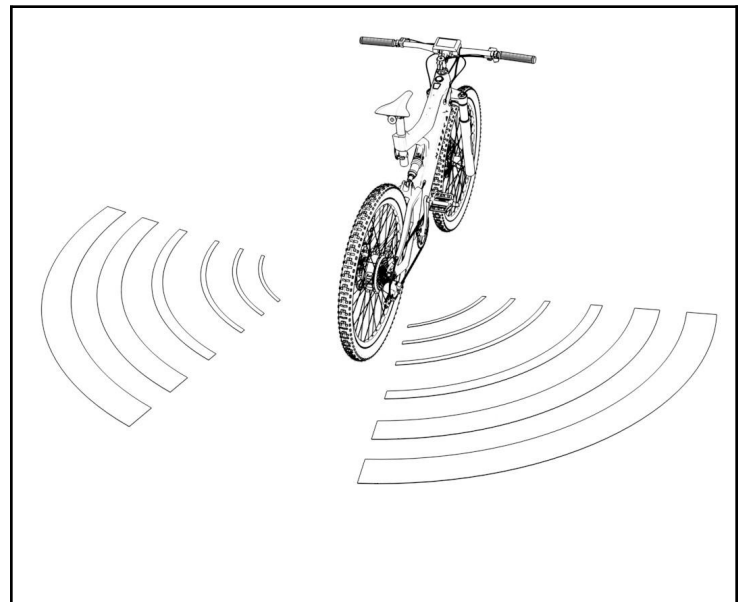

**ATTENTION:** You may turn the radars off when riding in urban areas to avoid unwanted alarms by stationary vehicles using the app.



---

# **GROUPSETS**

---

Nireeka Model	S-PART NO	SERIES	PART_CD	MODEL NO	DESCRIPTION
Homie (US&EU)	KSLM610RA	DEORE	SL	SLM610R	SHIFT LEVER, SL-M610, DEORE RIGHT 10-SPEED, 2050MM INNER W/ OPTICAL GEAR DISPLAY, BLACK
Homie (US&EU)	KRDM610SGSL	DEORE	RD	RDM610	REAR DERAILLEUR, RD-M610, DEORE, SGS 10-SPEED TOP-NORMAL, SHADOW DESIGN, DIRECT ATTACHMENT(DIRECT MOUNT COMPATIBLE), BLACK
Homie (US&EU)	KCSHG5010136	DEORE	CS	CSHG5010	CASSETTE SPROCKET, CS-HG50-10, 10-SPEED 11-13-15-17-19-21-24-28-3236T (BK), PRE-ASSEMBLED (CS CAP)
Homie (US&EU)	KCNHG54120	DEORE	CN	CNHG54	BICYCLE CHAIN, CN-HG54 SUPER NARROW HG FOR MTB 10-SPEED 120 LINKS, W/END PIN
Homie (US&EU)	AM60002JNFPR X095	DEORE	BD	BRM6000KIT M615	DISC BRAKE ASSEMBLED SET/J-kit, SHIMANO, BL-M6000(L), BR-M615(F), FOR POST MOUNT, RESIN PAD(W/O FIN), 950MM HOSE(SM-BH90-SS BLACK)
Homie (US&EU)	AM60002JTRXR X170	DEORE	BD	BRM6000KIT M615	DISC BRAKE ASSEMBLED SET/J-kit, SHIMANO, BL-M6000(R), BR-M615(R), W/O ADAPTER, RESIN PAD(W/O FIN), 1700MM HOSE(SM-BH90-SS BLACK)
Homie (US&EU)	ASMRT54S	DEORE	RT	SMRT54	ROTOR FOR DISC BRAKE, SM-RT54, S 160MM, W/LOCK RING, RESIN PAD
Homie (US&EU)	ASMRT56S	DEORE	RT	SMRT56	ROTOR FOR DISC BRAKE, SM-RT56, S 160MM, 6-BOLT TYPE, RESIN PAD
Homie (US&EU)	AHBM6000BL	DEORE	HB	HBM6000	FRONT HUB, HB-M6000, DEORE FOR CENTER LOCK(W/O LOCK RING) 32H OLD:100MM AXLE: 108MM QR:133MM(BLACK), W/O ROTOR MOUNT COVER BLACK
Street/Street+	ASLM3000RCT	ACERA	SL	SLM3000R	SHIFT LEVER, SL-M3000-R, ACERA, RIGHT, 9-SPEED, RAPIDFIRE PLUS, 2400MM STAINLESS INNER,W/ OPTICAL GEAR DISPLAY
Street/Street+	ARDM3000SGS	ACERA	RD	RDM3000	REAR DERAILLEUR, RD-M3000-SGS, ACERA, 9-SPEED, TOP-NORMAL, SHADOW DESIGN, DIRECT ATTACHMENT(DIRECT MOUNT COMPATIBLE)
Street/Street+	KCSHG4009136	ALIVIO	CS	CSHG4009	CASSETTE SPROCKET, CS-HG400-9, 9-SPEED, 11-13-15-17-20-23-26-3036(CB),PRE-ASSEMBLED (CS CAP)
Homie (US&EU)	KCNHG54120	DEORE	CN	CNHG54	BICYCLE CHAIN, CN-HG54 SUPER NARROW HG FOR MTB 10-SPEED 120 LINKS, W/END PIN
Street/Street+	AM3050LFURX0 95	ACERA	BD	BRM3050KIT	DISC BRAKE ASSEMBLED SET, ACERA, ST-M3050(L),BR-M3050(F) W/SM-MAF160P/S,RESIN PAD, 950MM HOSE(SMBH59 BLACK)
Street/Street+	AM3050JRRURX 170	ACERA	BD	BRM3050JKI T	DISC BRAKE ASSEMBLED SET/J-kit, ACERA, ST-M3050(R) ,BR-M3050(R) W/SM-MAR160P/S, RESIN PAD, 1700MM HOSE(SMBH59 BLACK)

Homie (US&EU)	ASMRT54S	DEORE	RT	SMRT54	ROTOR FOR DISC BRAKE, SM-RT54, S 160MM, W/LOCK RING, FOR RESIN PAD ONLY
Homie (US&EU)	ASMRT56S	DEORE	RT	SMRT56	ROTOR FOR DISC BRAKE, SM-RT56, S 160MM, 6-BOLT TYPE, FOR RESIN PAD ONLY
Street/Street+	AHBM3050B5	ACERA	HB	HBM3050	FRONT HUB, HB-M3050, 32H OLD:100MM AXLE:108MM, FOR CENTER LOCK ROTOR(W/O LOCK RING), QR:133MM W/O ROTOR MOUNT COVER, BLACK

Website: <http://www.nireeka.com>

User's manuals in other languages are available at [http://www.nireeka.com/user\\_manual](http://www.nireeka.com/user_manual)

FAQ: <http://www.nireeka.com/faq>

Forums: <http://www.nireeka.com/forum>